

TECHNICAL DATA SHEET

## Connector Interfaces

### For Amphenol AT Connector Series



The Harnessflex DT series provides safe and secure cable protection for Amphenol AT connectors with end cap modification, helping to maintain continuous vehicle operation even in the toughest conditions.

#### Features & Benefits:

- Provides continuation of cable protection between conduit and connector.
- Mechanical protection and a degree of ingress protection against solids.
- Protects against full force of jet washing, abrasion and vibration.
- Improves strain relief.
- Secure tamper resistant clip design.
- Available in straight and 90 degree options.

#### Applications:

- Construction vehicles
- Agricultural machinery
- Trucks
- Heavy duty and special purpose vehicles

#### Material:

- Polyamide 6,6 (Nylon)
- Very high UV resistance
- Heat stabilized (Self-extinguishing, low smoke toxicity & halogen free)

#### Compatible conduits:

- All Harnessflex conduits

#### Conformity:

- CE Mark to the low voltage directive
- RoHS Compliant to 2011/65/EU
- Conforms with end of life vehicle directive (ELV) EU200/53/EC

#### Temperature range:

- Normal use -40 to +120C

#### Ingress Protection:

- IP40

#### Chemical resistance:

- Please refer to [TDS000081](#)

**DT connector interface series: Connector compatibility**

**Amphenol - AT End Cap Series**

Part no.	Part no.	Interface	Connector
CI06-DT2	CI06-90-DT2	2 way	AT04-2P**
CI08-DT2	CI08-90-DT2		
CI12-DT2	CI12-90-DT2		
CI06-DT4	CI06-90-DT4	4 way	AT04-4P** / AT06-4S**
CI08-DT4	CI08-90-DT4		
CI12-DT4	CI12-90-DT4		
CI06-DT6	CI06-90-DT6	6 way	AT04-6P** / AT06-6S**
CI08-DT6	CI08-90-DT6		
CI12-DT6	CI12-90-DT6		
CI12-DT8	CI12-90-DT8	8 way	AT04-08P**
CI16-DT8	CI16-90-DT8		

\*\* Compatible with part number suffix: EC\*\*, MM\*\* (except MM03\*\*)

**DT connector interface series: Part numbers and dimensions**

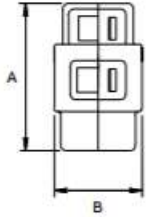

Part No.	Conduit size		Nominal dimensions (mm)		
	NC	NW	A	B	C
CI06-DT2	06	4.5	26.0	16.0	18.0
CI08-DT2	08	7.5	26.0	16.0	18.0
CI12-DT2	12	10	26.0	16.0	18.0
CI08-DT3	08	7.5	30.0	22.0	24.0
CI12-DT3	12	10	29.0	22.0	24.0
CI08-DT4	08	7.5	42.0	18.0	27.0
CI12-DT4	12	10	40.0	18.0	27.0
CI08-DT6	08	7.5	42.0	22.0	27.0
CI12-DT6	12	10	40.0	22.0	27.0
CI12-DT8	12	10	40.0	25.0	30.0
CI16-DT12	16	13	44.0	24.0	40.0

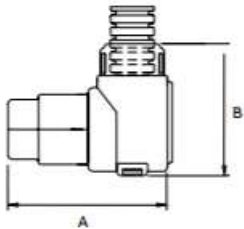

Part No.	Conduit size		Nominal dimensions (mm)		
	NC	NW	A	B	C
CI06-90-DT2	06	4.5	36.0	30.0	19.0
CI08-90-DT2	08	7.5	36.0	30.0	19.0
CI12-90-DT2	12	10	36.0	30.0	19.0
CI08-90-DT3	08	7.5	44.0	30.0	23.0
CI12-90-DT3	12	10	44.0	30.0	23.0
CI08-90-DT4	08	7.5	48.0	30.0	25.0
CI12-90-DT4	12	10	48.0	30.0	25.0
CI08-90-DT6	08	7.5	48.0	34.0	25.0
CI12-90-DT6	12	10	48.0	34.0	25.0
CI12-90-DT8	12	10	63.0	37.0	30.0
CI16-90-DT8	16	13	63.0	37.0	30.0
CI12-90-DT12	12	10	68.0	36.0	38.0
CI16-90-DT12	16	13	68.0	36.0	38.0

ABB UK Ltd  
CMG House, Station Road,  
Coleshill, Birmingham  
B46 1HT  
Tel: +44 (0) 115 964 3700  
Email: sales@harnessflex.co.uk

We reserve the right to make technical changes or modify the contents of this document without prior notice. With regard to purchase orders, the agreed particulars shall prevail. ABB does not accept any responsibility whatsoever for potential errors or possible lack of information in this document.

We reserve all rights in this document and in the subject matter and illustrations contained therein. Any reproduction, disclosure to third parties or utilisation of its contents, in whole or in parts, is forbidden without prior written consent of ABB. Copyright© 2020 ABB.

All rights reserved.

[www.hpankajelectricals.com](http://www.hpankajelectricals.com)

9AKK108467A1052 07.22